

# The High Seas Explorer

Rfa110

**TOROSPLAY**



Serial number	Rfa110
Product line	Robinia Ships
Dimensions	≈ 1924*1147 cm
Height	≈ 980 cm
FFH	300 cm
In accordance with norm EN	EN1176:17
Age group	6 +
Key user group	6 – 12 years
Inclusive	No
Number of users	54
Platform height	125 / 200 / 300 cm

## Warranty

**10**

**10-year guarantee** - Coverage includes structural failure of the robinia components and structures.

**5**

**5-year guarantee** - Structural strength of steel and stainless steel components

**2**

**2-year guarantee** - Structural failure of high density polyethylene and plastic components

Check the warranty card for more information

**Torosplay Ltd.**  
Bulgaria  
8000, Burgas  
55 "Kraina" Street  
South Industrial Zone

## Activities





The Robinia wood can be supplied as untreated raw wood, painted with a brown coloured transparent pigment that maintains the golden wood colour or in a coloured version where selected components are painted in different colours.



Two barrels to compliment the pirate experience.

### Torosplay Ltd.

Bulgaria  
8000, Burgas  
55 "Kraina" Street  
South Industrial Zone



Extreme tube slide for fun and safe descent.

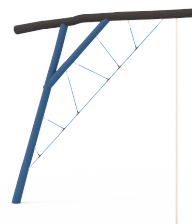

Climbing net and a metal bar that stimulates children's strength and coordination.

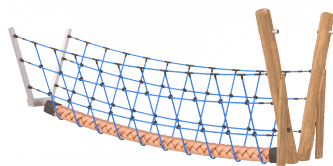
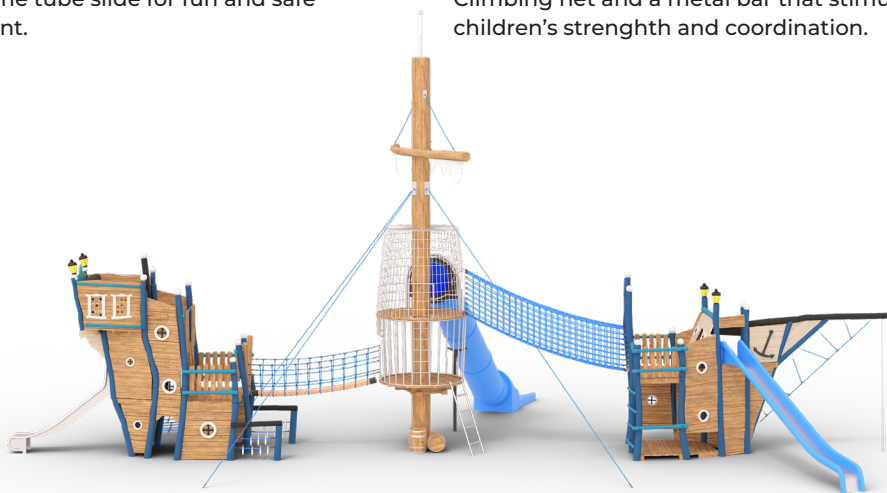

Single rope bridge that connects the quarterdeck to the main mast.

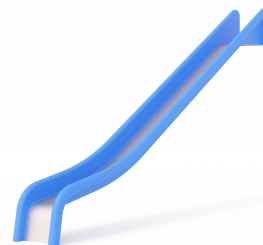

High speed GRP slide for fun and safe descent.

# TOROSPLAY

## Options

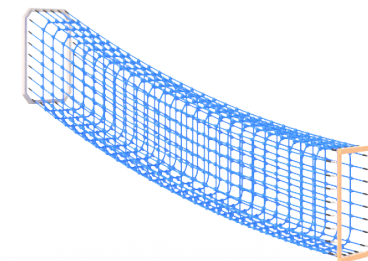

Extreme horizontal bridge connecting the main mast with the forepeak



Metal cage on two levels allowing the children to reach the tube slide.



Exclusive piece of art that reassembles ship from the golden age of seafaring. Made of Robinia the ship is authentic. It features a mast that has two decks installed one above the other. Kids climb to the first deck by the means of a stainless steel ladder. From there they can head up to the back part of the ship via a thick rope bridge or climb on the second deck and choose either to exit via the tubular slide or to continue to the front part of the ship via the closed rope bridge. The front part is equipped with a slide, a climbing wall, climbing net and decorations. The back part features three deck on different levels and entry and exit points as well as a ladder, rope net and many many decorations.

## Cargo details



One truck or container: 900 \* 220 / 3475 kgs.

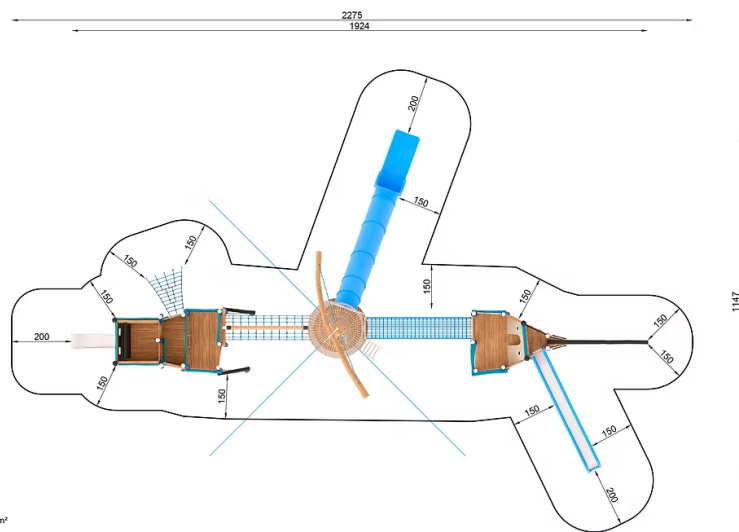

**Torosplay Ltd.**

Bulgaria  
8000, Burgas  
55 "Kraina" Street  
South Industrial Zone





The hardware is made of stainless steel or galvanized steel to ensure durable connections with a high corrosion resistance. This robust construction guarantees long-lasting performance even in harsh environments.



Design your own:  
Wide color pallet to choose colors from  
We use only certified EN71 chemical free paints

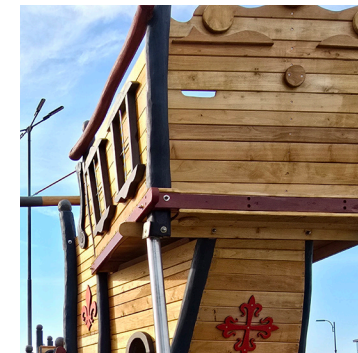

Robinia boards – 9/14 \* 2,5.  
Sanded, chamfered R=5mm,  
Quality – A,B



Robinia poles 14 – 22 cm in diameter, best possible quality, sanded



16 and 18 mm  
PP-Multifilament & split film  
Or Braided nylon  
Steel core – highest quality



Solid T and X connector ensure the  
Durability of the nets we produce



**Torosplay Ltd.**  
Bulgaria  
8000, Burgas  
55 "Kraina" Street  
South Industrial Zone



Material: PP with steel core

**TOROSPLAY**

## Surfaces according to EN 1176-1:2017

	Description (mm)	Layer thickness (cm)	Maximum fall heights (cm)
Turf/ top layer of soil (A,B,C)	-	-	≤100
bark (A,C)	Particle size from 20	30	≤200
		40	≤300
woodchips (A,C)	Particle size from 5 to 30	30	≤200
		40	≤300
sand or gravel (A,C)	Particle size from 0,25 to 8	30	≤200
		40	≤300
synthetic attested (A,B,C)	Fill in Tested according to EN 1177		100

**TOROSPLAY**

## Installation method Type A: ≈ 8 m<sup>3</sup> concrete into the ground

